



STUDY ABROAD & EXCHANGE BRIEFING DAY 16th February 2018

Dear Student

The Study Abroad and Exchange Briefing Day introduces you to Melbourne Global Mobility, Stop 1, the University and to other students joining the program. This day provides helpful information on settling into life in Melbourne, as well as the opportunity to attend information sessions to help you finalise your subject selection and timetable.

WHERE DO I GO? WHAT DO I BRING?

You must bring your **passport** to verify your identity and **complete your registration**. Student registration will take place at the Melbourne School of Design and there will be plenty of signage to help you find the location on the day.

WHAT HAPPENS ON THE DAY?

TIME	ACTIVITY	LOCATION	MAP REF
9.30am – 10.30am	Register your arrival before 10.30am (compulsory)	Melbourne School of Design Basement Foyer	1
10:30am – 12:15pm	Welcome Briefing - Providing important information about adapting to your new study environment with such topics as Australian culture, your visa, and safety and support services (compulsory)	B117 Theatre, Melbourne School of Design J.H. Michell Theatre, Peter Hall Building	1, 2
12.15pm – 2.00pm	Lunch BBQ - Opportunity to meet fellow commencing students and take a break. Staff/Students from Global Mobility, Melbourne Sport and Melbourne University Student Exchange Club will be present to help with any enquiries	North Court, Union House	3
1.00pm – 2.00pm	Campus Tour – Explore the campus over lunch	North Court, Union House	3
2.00pm – 2.45pm	Subject Enrolment and Timetable Advice	B117 Theatre, Melbourne School of Design	1
3.00pm – 3.45pm	Housing Information Session	B117 Theatre, Melbourne School of Design	1
4.00pm – 5.00pm	Making the Most of Melbourne	B117 Theatre, Melbourne School of Design	1

ACCESSING WIFI

The University of Melbourne's wireless network is *UniWireless* and is available everywhere on campus. If you have completed your administrative enrolment, you will have access to this network, and can connect by using your University of Melbourne username and password. In order to connect to *UniWireless*, you may first need to set up your device. You can do this automatically using the device configuration tool or manually using a configuration guide while on-campus. Printed versions of the guides are available at the Baillieu Library service desk.

ORIENTATION: MAKE THE MOST OF MELBOURNE

A comprehensive list of activities can be found on the Orientation website:

 <https://orientation.unimelb.edu.au/>

ADMINISTRATIVE AND SUBJECT ENROLMENT

Instructions on how to complete your online administrative and subject enrolment, and set up your timetable, were provided to you prior to Briefing Day. If you need to access these instructions again, please refer to the Get Started website:

 <https://students.unimelb.edu.au/get-started/saex>

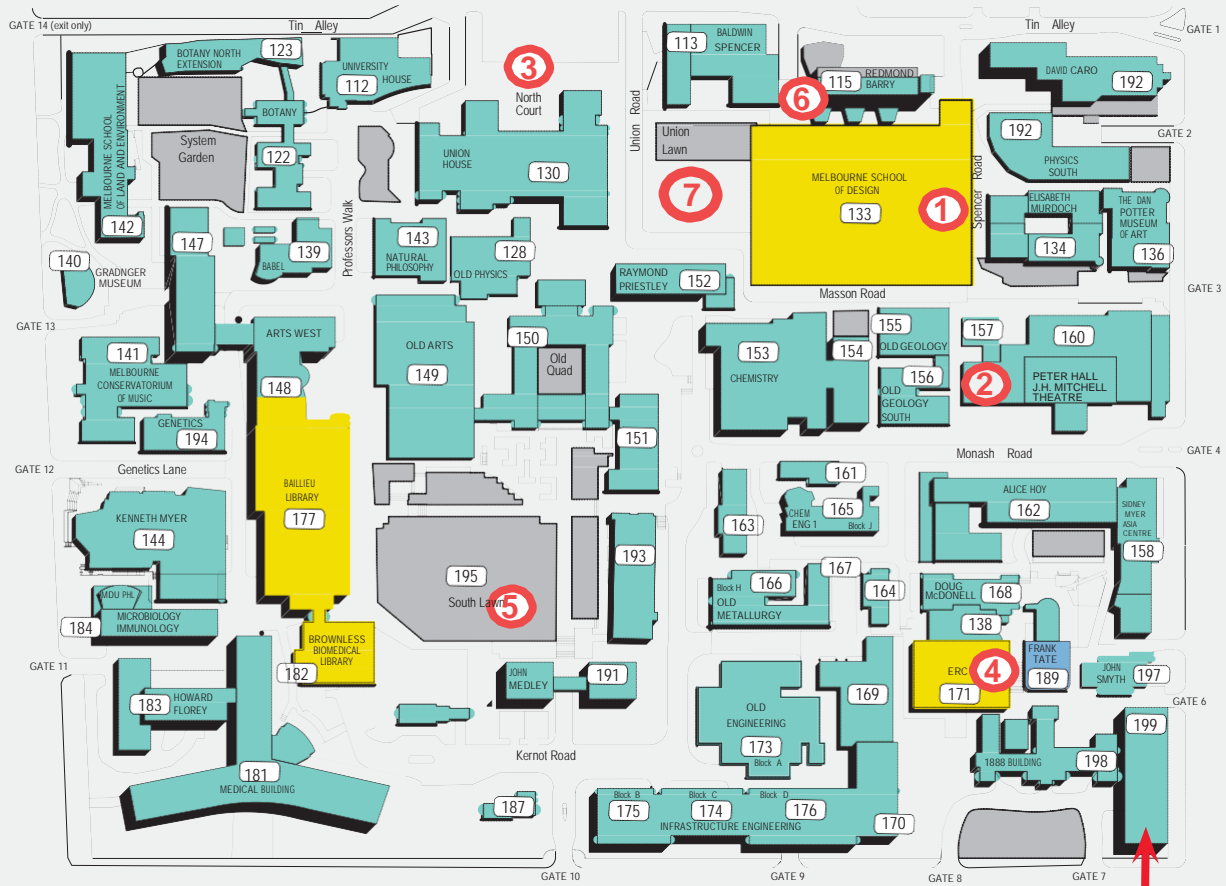

Published by: University Services
 CRICOS Code: 00116K
 Information correct as of February 2017

GRATTAN STREET

STOP 1